



DRAWING LEGEND

- DEVELOPED PARCEL
- DEVELOPMENT PARCEL
- PUBLIC ACCESS
- ROW / PUBLIC ACCESS
- CRAFTSMAN DISTRICT
- PDO BOUNDARY (APPROXIMATE)
- PARCEL LINES

- 1 PACIFIC RIM PLAZA & SPLASH FOUNTAIN
- 2 ESPLANADE AT FISHERMAN'S HARBOR
- 3 DOCK WALK
- 4 SEINER WHARF
- 5 SEINER PIER
- 6 CLOCKTOWER COURTYARD
- 7 WORKMAN'S CLOCKTOWER
- 8 TIMBERMAN TRAIL
- 9 CHAMFER WOONERF
- 10 FISHERMAN'S TRIBUTE
- 11 NORTHEAST VISTA
- 12 NORTH ESPLANADE
- 13 WEYERHAEUSER MUSE
- 14 BOXCAR PARK
- 15 BOXCAR PICNIC SHELTER
- 16 WEST ESPLANADE
- 17 WEST VISTA
- 18 PROMENADE
- 19 SOUTHWEST VISTA
- 20 SOUTH ESPLANADE
- 21 SOUTHEAST VISTA
- 22 JETTY LANDING PICNIC SHELTERS
- 23 COMMODORE PLAZA

- P1 SURFACE
- P2 SURFACE / RES. DEDICATED
- P3 SURFACE / RES. DEDICATED
- P4 SURFACE
- P5 SURFACE
- P6 STRUCTURE
- P7A MARINA PARKING LOT (A)
- P7B MARINA PARKING LOT (B)
- P7C MARINA PARKING LOT (C)
- P8 SURFACE
- P9 COURT
- P10 STRUCTURE
- P11 SURFACE
- P12 SURFACE
- P13 STRUCTURE / RES. DEDICATED
- P14 STRUCTURE / RES. DEDICATED
- P15 SURFACE

- D4-A PARCEL D4 - BUILDING A
- D4-B PARCEL D4 - BUILDING B
- D4-C PARCEL D4 - BUILDING C
- D4-D PARCEL D4 - BUILDING D
- D4-E PARCEL D4 - BUILDING E

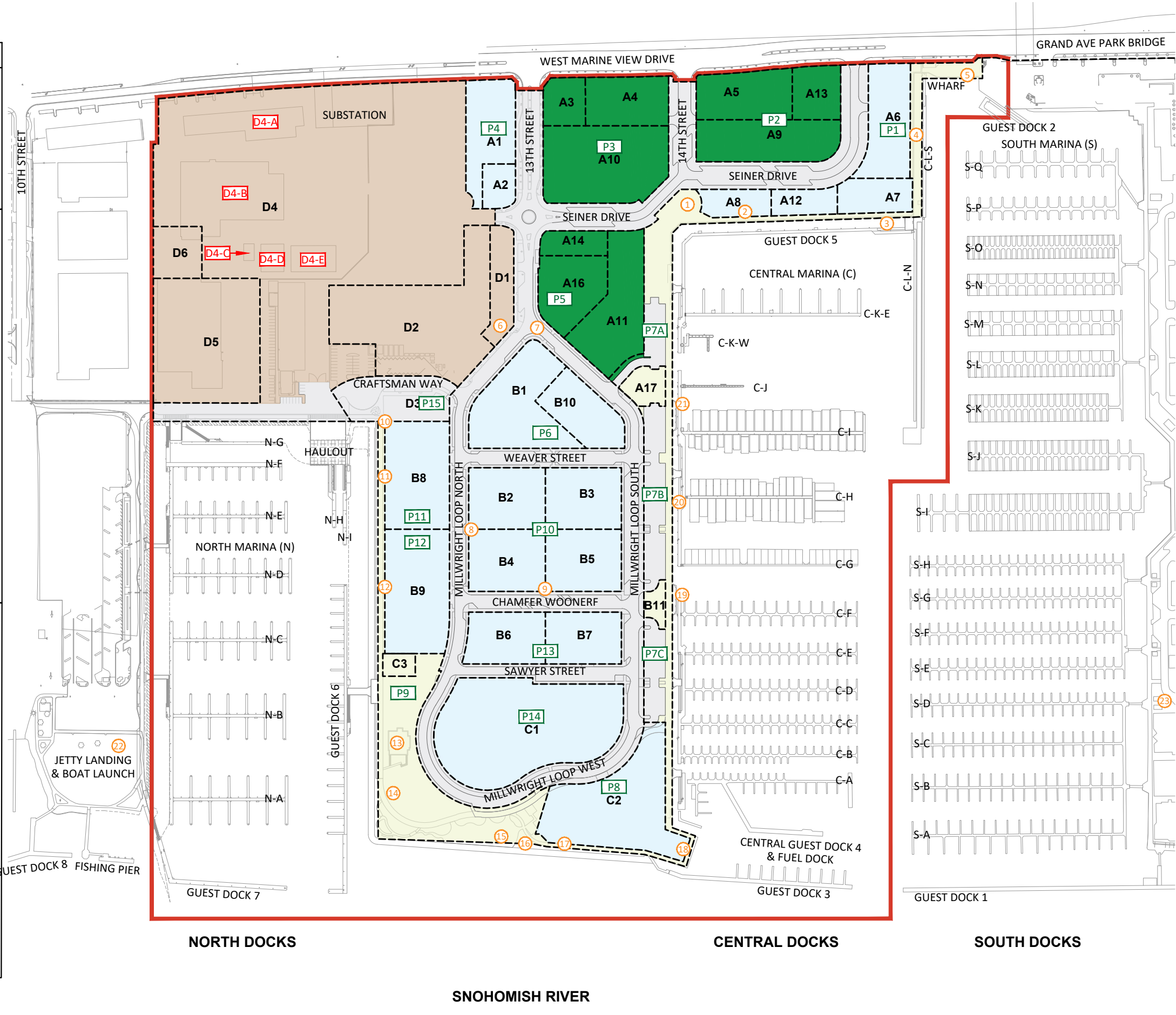

SITE AREA SUMMARY

PARCEL	USE TYPE	SITE AREA (ACRES)
A1	COMMERCIAL	1.00
A2	COMMERCIAL	0.19
A3	RESIDENTIAL	0.38
A4	RESIDENTIAL	0.78
A5	RESIDENTIAL	0.87
A6	COMMERCIAL	0.95
A7	COMMERCIAL	0.49
A8	COMMERCIAL	0.37
A9	RESIDENTIAL	1.14
A10	RESIDENTIAL	1.79
A11	HOSPITALITY	1.34
A12	MARKET	0.33
A13	COMMERCIAL	0.48
A14	COMMERCIAL	0.32
A15	- REMOVED -	0.00
A16	COMMERCIAL	0.85
A17	MARINA RESTROOM	0.27
SUBTOTAL		11.55
B1	EMPLOYMENT	1.42
B2	EMPLOYMENT	0.91
B3	EMPLOYMENT	0.90
B4	RESIDENTIAL	0.92
B5	RESIDENTIAL	0.91
B6	RESIDENTIAL	0.78
B7	RESIDENTIAL	0.76
B8	EMPLOYMENT	1.36
B9	EMPLOYMENT	1.52
B10	EMPLOYMENT	0.78
B11	MARINA RESTROOM	0.15
SUBTOTAL		10.41
C1	RESIDENTIAL	3.15
C2	COMMERCIAL	2.03
C3	MARINA RESTROOM	0.14
SUBTOTAL		5.32
D1	MARINE/RETAIL	0.72
D2	COMMERCIAL/MARINE	2.79
D3	PARKING AREA	0.52
D4	BOATYARD	13.84
D5	LIGHT INDUSTRIAL	2.55
D6	LIGHT INDUSTRIAL	0.48
SUBTOTAL		20.90
TOTAL SITE AREA		48.18

WATERFRONT PLACE CENTRAL
TOTAL AREA: 65.17 ACRES

